





8a, Catherine Street, Cheshire, SK11 6ET

Located in the heart of Macclesfield town centre, this charming and spacious three-bedroom mid-terrace cottage offers the perfect blend of character and convenience. Light and airy throughout, the property features a generous open-plan kitchen, dining, and utility area, along with a separate cosy lounge. A small private yard to the rear and a single parking space. Just a short walk from local shops, restaurants, and excellent transport links, this property is ideal for a professional couple or family looking for comfort and accessibility.

Key Features:

- Three well-proportioned bedrooms
- Spacious open-plan kitchen, dining, and utility area
- Light and airy throughout
- Small private rear yard
- Single parking space
- Prime town centre location
- Walking distance to shops, restaurants, and transport links

Available start of September and offered part furnished with white goods. Tax Band B. EPC C. No pets will be considered. A £100 Holding Deposit must be paid within 24 hours of an offer being accepted.

Viewings by appointment with Holden and Prescott 01625 422 244.

Location:

SK11 6ET, Catherine Street. Property is located on the left hand side when approached via Chestergate.

Proceed out of Macclesfield along Hibel Road continuing left into Churchill Way. Take the third turning on the right hand side into Roe Street which continues into Shaw Street. At the next junction turn right into Catherine Street where the property can be found on the right hand side.

Viewing: By appointment with Holden and Prescott 01625 422244

HOLDEN & PRESCOTT

Entrance Hall

Lounge

12'4 x 11'2

Dining Kitchen

22'10 x 11'8

Utility Area

7'9 x 3'1

Landing

Bedroom One

20'3 in total x 9'2 max

Bedroom Two

12'1 x 9'2

Bedroom Three

16'11 x 6'5

Bathroom

£1,250 PCM

HOLDEN & PRESCOTT

Ground Floor

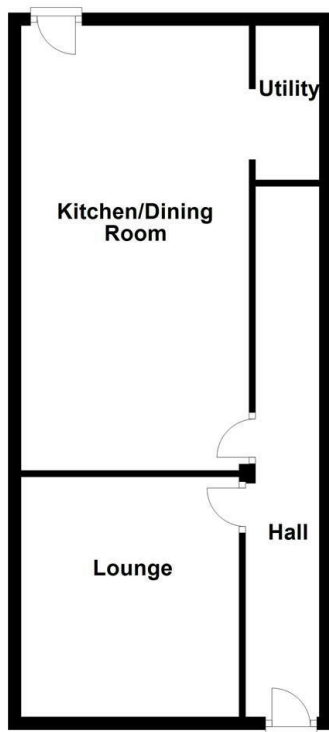

First Floor

